

2004 Rendezvous Bradenton, FL April 1 - 4

Hosts: Jim Wick & Bob Bothum, Dick & Maureen Avery, Tim & Lynne Gressett

The 2004 Rendezvous was held in April in Bradenton, Florida. Attendants were treated to both a tour of the new CC plant in St Petersburg (no photography allowed!) and a tour of the 60' Commander Stardust.



First group of two lined up in front of the present Chris Craft head office and factory. Front row: Alarik von Hofsten, Dick Avery, Chris Orphal, Jamie Rolison. Top row: xx, yy, Robert Cutchins, Jim Wick, Bob Bottum, Mrs Gressett, Tim Gressett, Julie Orphal, Lyn Orphal, Clif Orphal.



Chris Craft Commander 31' Bonnie Dick, owned by Tim Gressett.



Chris Craft Commander 38' Miss Jeanette, owned by Herb Brock.



Chris Craft Catalina 381 Spindrift, owned by Dick Conrad.



Chris Craft Commander 38' Miss Jeanette, owned by Herb Brock.



Chris Craft Commander 35' Best Mate, owned by John Colombo



Chris Craft Commander 38' Miss Jeanette, lower helm station



All laughs when trying to solve Tim's trivia questions. Jim Wick, Julie Thomas, Bob Bothum, Linda Orphal, Clif Orphal, Chris Orphal,



Tim Gressett door prize presenter and member of the team that organised the Rendezvous.



Dick Avery, designer of most of the Chris Craft Commanders made in the sixties. Dick was also on the team that organised the Rendezvous and acting as toastmaster at our dinner parties.



Dick and Maureen Avery.



John and Bev Colombo door prize winners and members organising team at the Rendezvous.



Patty & Dick Morland proudly showing Pattys purse made in all wood closely resembling a classic motorboat transom. Dick claim the bottom paint is actually real antifouling paint!



Dick Morland and Patty Morland waiting for the Commander fleet to cast off for a Saturday morning cruise.



Jim Wick and Bob Bothum of LPX-Sales both wearing hats with the crest of the Royal Motorboat Club of Sweden (Kungliga Motorbat Klubben).



Dick Avery at Captain's briefing meeting before cast off.



Bonnie Dick moving out of the marina.



Last preparation onboard Miss Jeanette before the cruise with participating boats and members.



Miss Jeanette proving she has got the strongest (and newest!) engines in the fleet. MerCruiser 7,4 makes for good speed.



Miss Jeanette proving she has got the strongest (and newest!) engines in the fleet. MerCruiser 7,4 makes for good speed.



Bonnie Dick making good speed.



Bonnie Dick and Spindrift.



Spindrift following us into the Marina.



Sue Conrad onboard Spindrift.



The majestic bow of Tom & Wendy Giddings' Chris Craft Commander 60 Stardust.



Helmstation of Stardust.



The maintenance and laundry room onboard Stardust. Plenty of room for washer, dryer, tools, work bench etc.



Originally the cabin for the crew but now the home office for the owners.



The impressive helm station.



Owner Tom Giddings surprised us all by letting the original designer of the 60' Commander, Dick Avery, sign his masterpiece. In spite of all boats he designed this is the first one he actually signed!



The engine room.



The master stateroom.



The main salon, with Dick Avery and Robert Cutchins discussing the interior.



Stardust's impressive foredeck.



Curt Radford on the bow of Stardust. Looking pleased!



The cabin of Bonnie Dick.



The lower helmstation of Bonnie Dick.



Miss Jeanette making her way back to Twin Dolphin Marina.



Curt Radford



Bruce Donaldson, former President of Chris Craft, giving a speech about the heydays of Chris Craft.



Gordon Howser, former advertising & public relations at Chris Craft told a lot of anectotes about Chris Craft marketing and PR.



Tom Giddings proudly wearing his KMK hat. (Kungliga Motorbåtsklubben).



Dick Avery brought along some of his original work as a designer at Chris Craft.

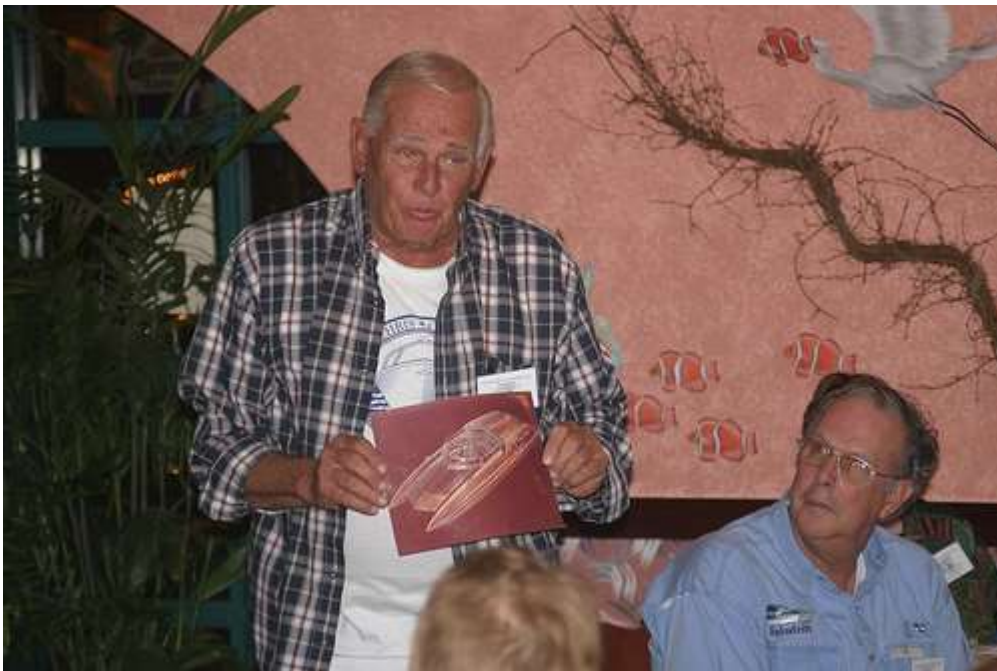





Dick Avery brought along some of his original work as a designer at Chris Craft. During some difficult times in the boating industry Dick tried to create interest in something different, the Chris-Home!



Design sketches of a very rare Commander, the 57' Commander Sport Fisherman. It is infact so rare that most experts didn't even know it existed. This is one of several sketches proposed by Dick Avery.

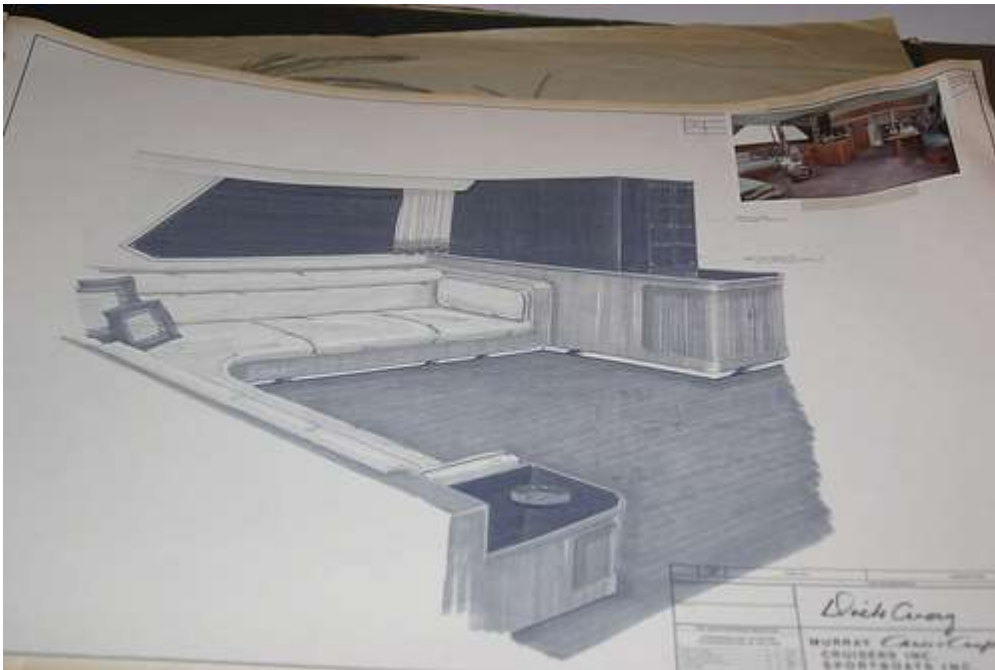

Design sketches of a very rare Commander, the 57' Commander Sport Fisherman. It is infact so rare that most experts didn't even know it existed. Two were commissioned, but probably just one was built. This is one of the Interior sketches proposed by Dick Avery.

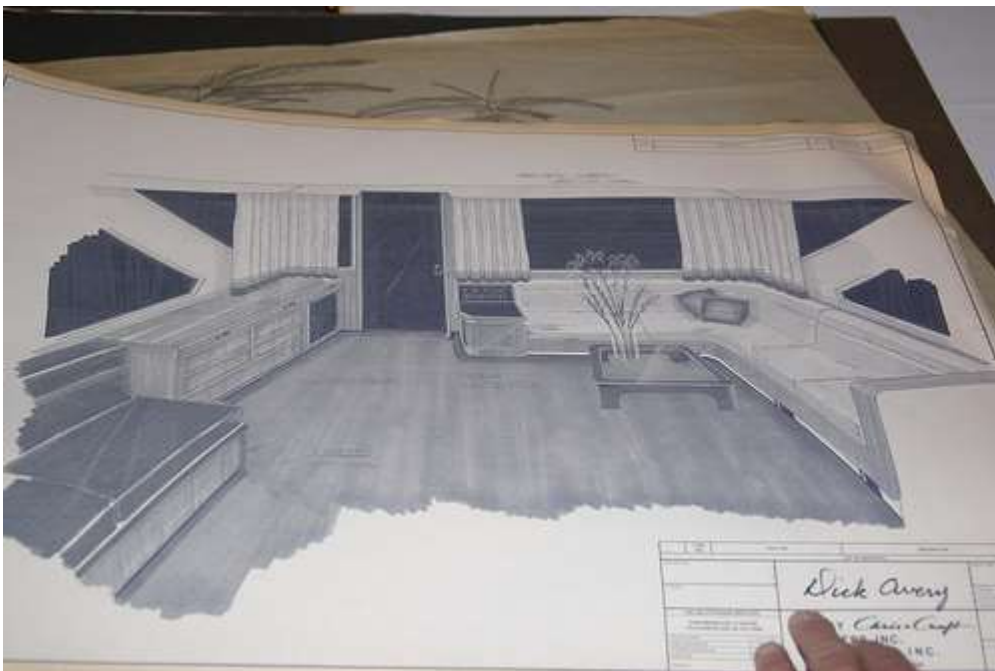

Design sketches of a very rare Commander, the 57' Commander Sport Fisherman. It is infact so rare that most experts didn't even know it existed. Two were commissioned, but probably just one was built. This is one of the Interior sketches proposed by Dick Avery.



Jim Wick and Bob Bothum showed me one of their warehouses at LPX-Sales.